

INSTRUCTIONS FOR FASTENING THE PANEL AND FOLLOW-UP OF THE DIMENSIONS

FACADE CLADDINGS / RUUKKI PREMIUM PANELS PRIMO SKYLINE 150

RUUKKI

FASTENING OF THE PANEL

The panel is hung on support brackets CA1SB01 and fastened from the top. Support brackets are fastened to studs CA1SS1. For a uniform vertical joint a gap template CA3JGT is recommended.

See the other side of this sheet for a visual overview of the installation process. Use the QR code for a video overview.

- Pay close attention to the leveling of the first row of cassettes
- Remove drilling and cutting debris immediately to avoid rust spots
- Use of an angle grinder is forbidden
- Use touch-up paints for any scratches
- Protect products from dirt (e.g. mortar, paint, PU-foam) during the whole time as they are very difficult to remove afterwards

FOLLOW-UP OF THE DIMENSIONS

Follow the A-, B- and Dh/Dv-dimensions. Check the dimensions from the plans! Check the module height with the measuring tape constantly!

Panel tolerances: ± 1 mm (A-, B- and Dh/Dv-dimensions)

Sub frame tolerances in horizontal direction:

- For one panel: ± 1 mm
- Between each support studs: ± 1 mm

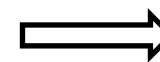
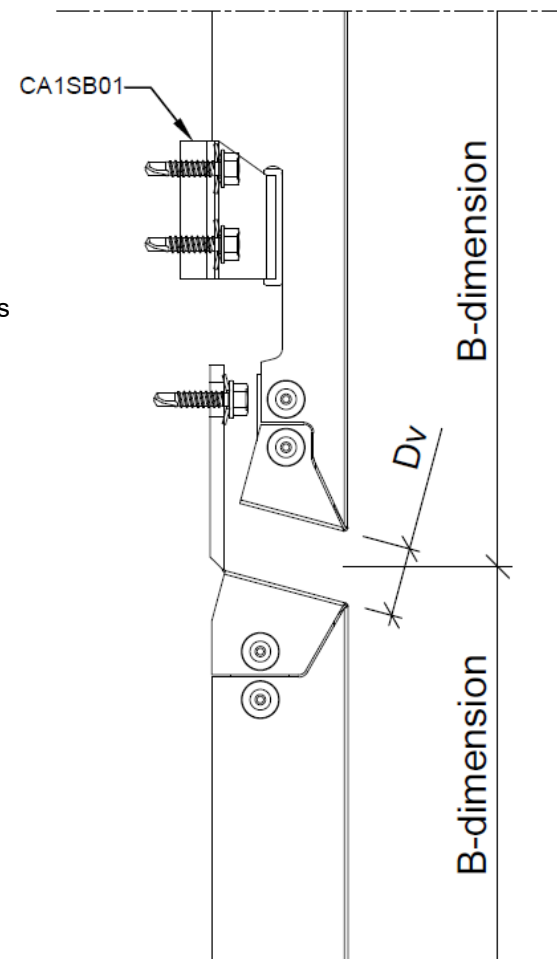
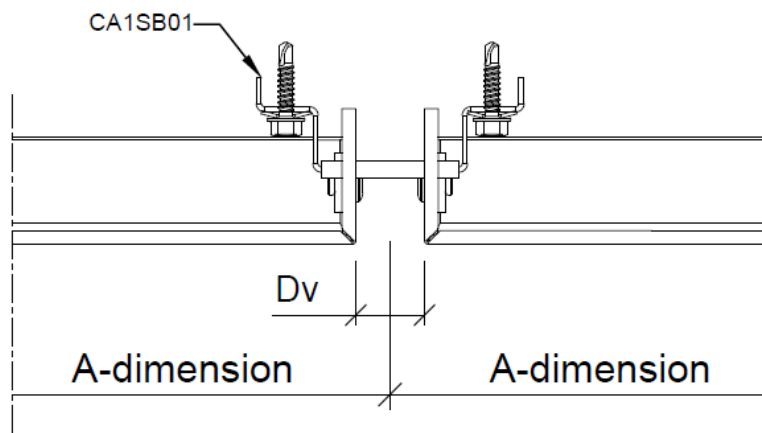



1 - Install brackets CA1SB01 to studs 73 mm from the bottom.
This is where the bottommost part of Skyline 150 is situated.

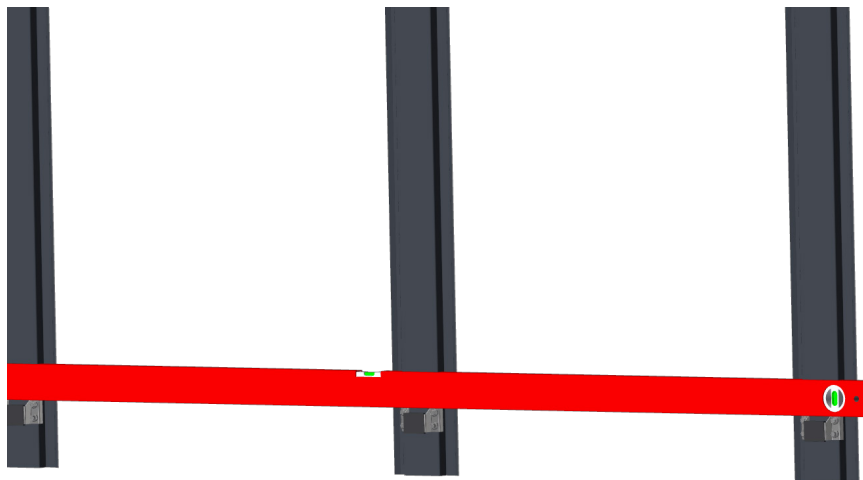

2 - Make sure to level the first row of brackets

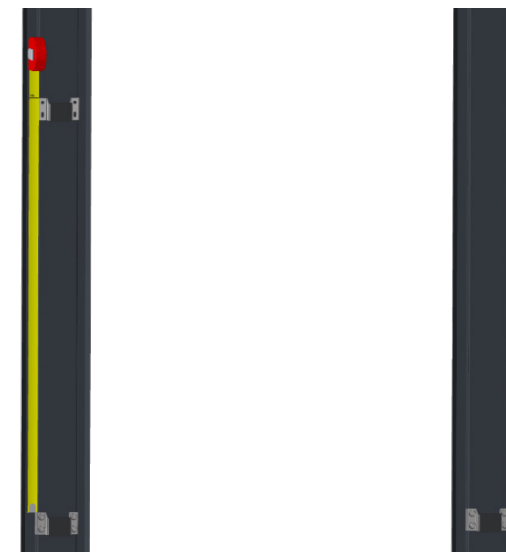

3 - Follow with the next row of brackets 750 mm above previous



4 - Start installing the panels by sliding them onto the brackets

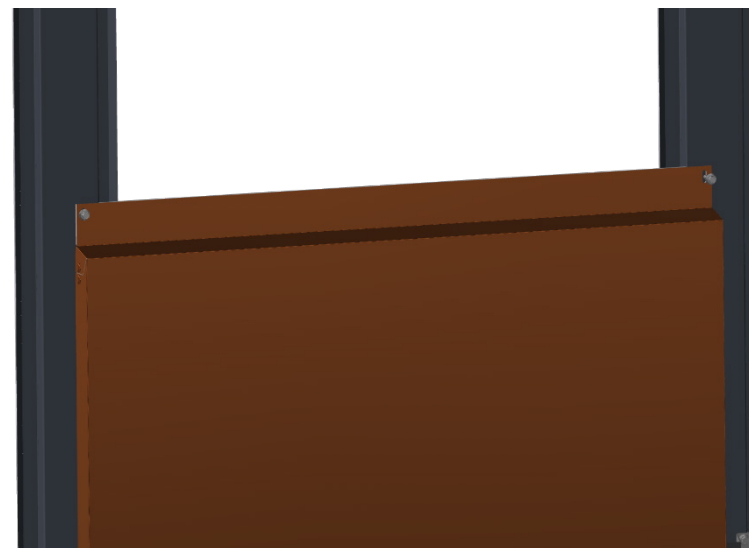

5 - Fasten the panel from the top oval holes



6 - Continue installing the panels using gap templates CA3JGT for a uniform vertical joint

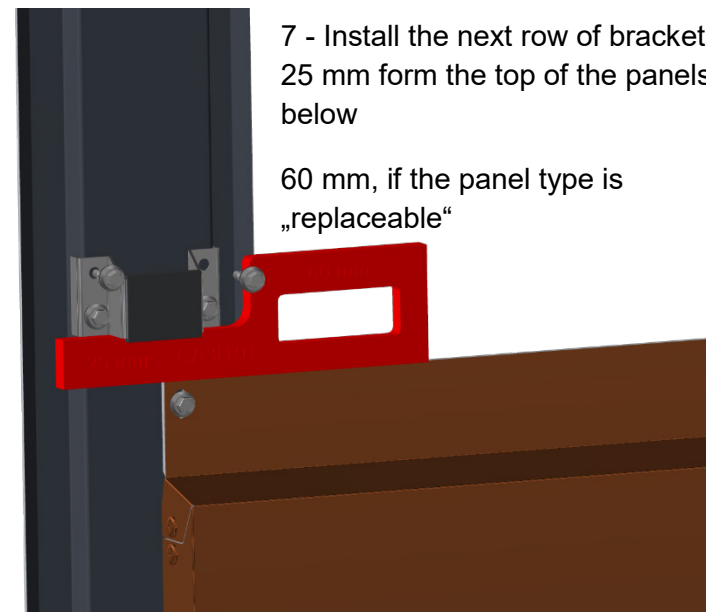

7 - Install the next row of brackets 25 mm from the top of the panels below

60 mm, if the panel type is „replaceable“

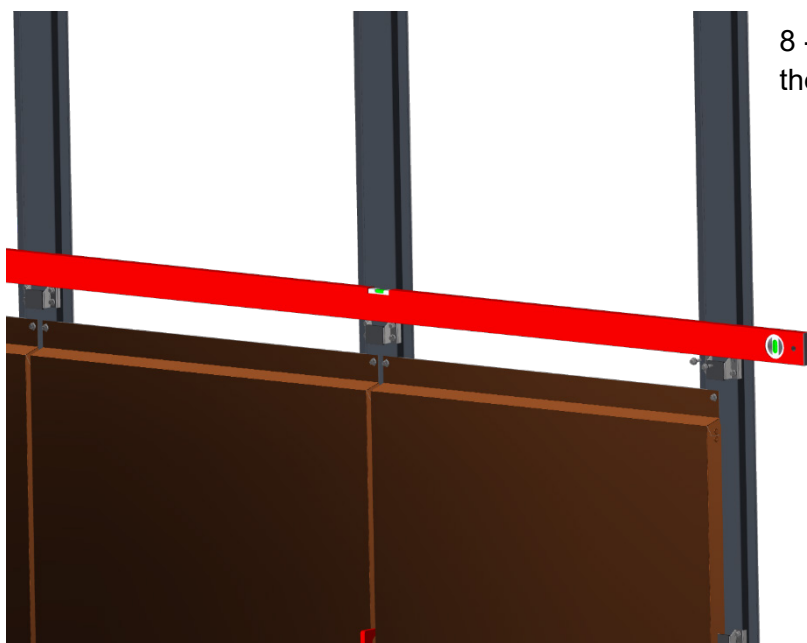

8 - Make sure to level the brackets once again

9 - Continue installing the panels using the gap templates

