

INSTRUCTIONS FOR FASTENING OF THE PROFILE AND FOLLOW-UP OF THE DIMENSIONS

FACADE CLADDINGS / DESIGN PROFILES DESIGN ROME S34 COR-TEN®

RUUKKI

FASTENING OF THE PROFILE

Minimum fastening to each support stud:

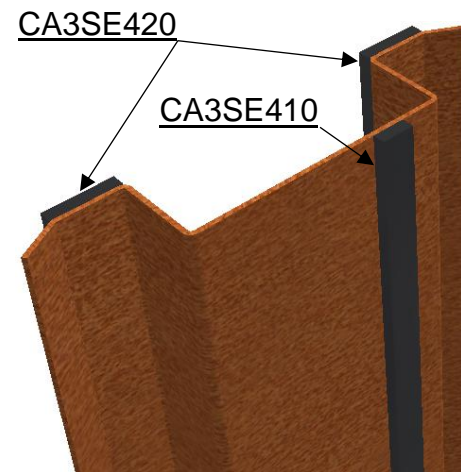

1. Add separating strips CA3SE420 between backing wall and support stud and separating strip CA3SE410 between support stud and design profile

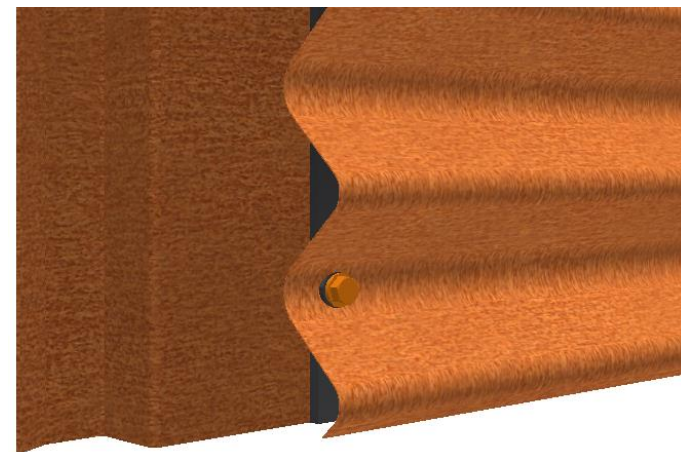

2. Add fasteners to the lowest wave bottom

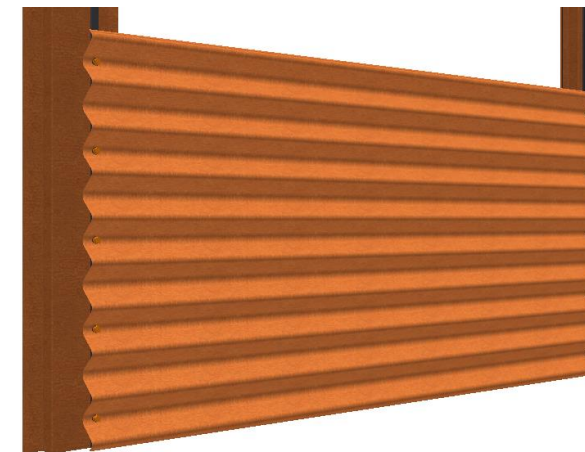

3. Add fasteners to every second wave bottom

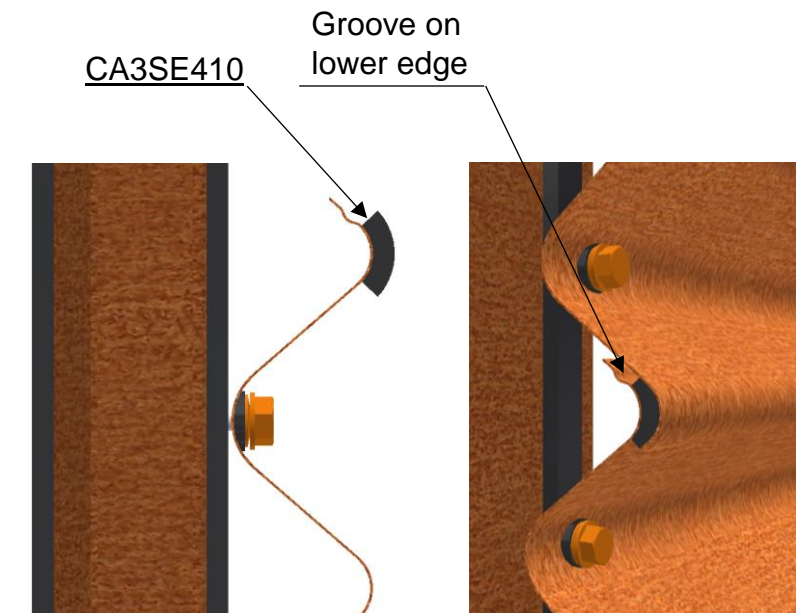

4. At the overlapping add separating strip CA3SE410 and fasteners to the lowest wave bottom

If necessary, add fasteners to any loose edge.

Recommended fasteners:

- For fastening to support stud (e.g. CA1SS4), use screws S3R48022D02A0B

Recommended spacing between support studs: c/c 600 - 900 mm

COR-TEN® surfaces must be separated from each other and other surfaces by separating strips (EPDM rubber).

Final execution must be according to the structural designer's instructions!

FOLLOW-UP OF THE DIMENSIONS

Follow the effective width. Effective width is 898 mm.

Check the dimensions from the plans!

Profile tolerances:

- Effective width ± 5 mm
- Length $+10, -5$ mm

Sub frame tolerances in horizontal direction:

- For one profile: ± 1 mm ($L \leq 3000$ mm) or ± 2 mm ($L > 3000$ mm)
- Between each support stud: ± 1 mm

VERTICAL JOINT

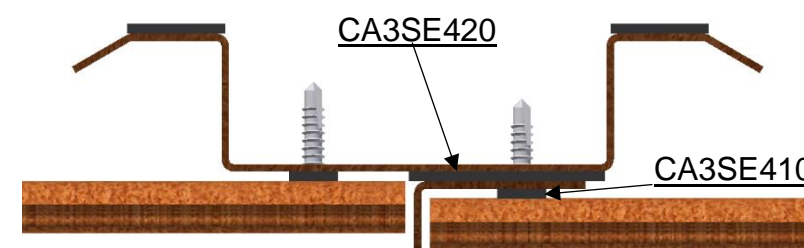

a) With vertical joint flashing

Use separating strips CA3SE420 between support stud and vertical joint flashing and separating strip CA3SE410 between vertical joint flashing and design profile

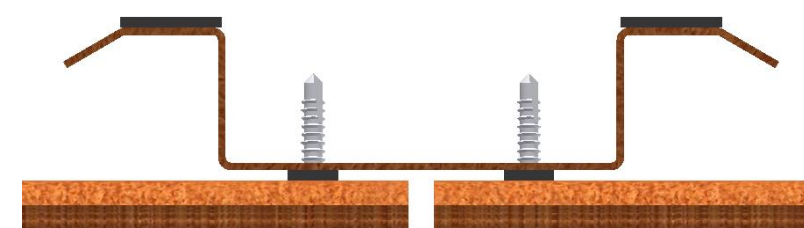

b) Without vertical joint flashing

-> Note: Profile ends do not overlap

