

INSTRUCTIONS FOR FASTENING THE PANEL AND FOLLOW-UP OF THE DIMENSIONS

FACADE CLADDINGS / CLADDING LAMELLAS LAMELLA GROOVE 10

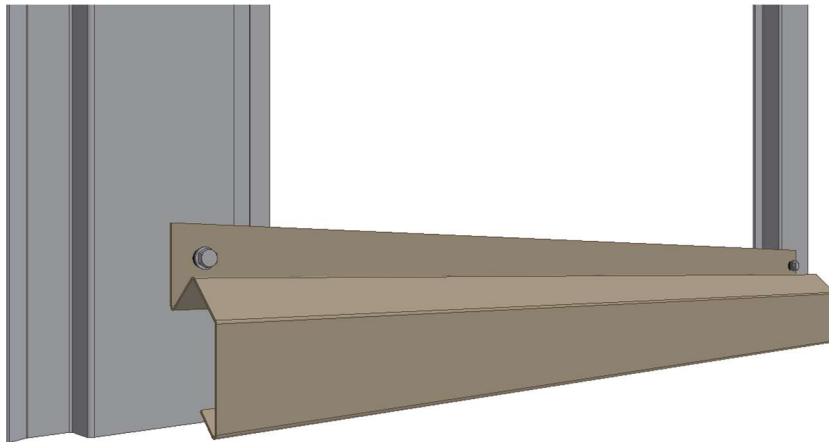

FASTENING OF THE LAMELLA



1. Add fasteners to the upper edge of the starting fillet CA1SF3, the joint should be at the center of the stud.

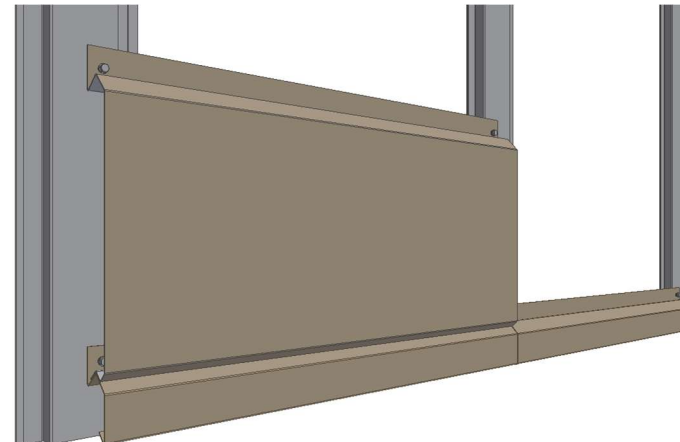

2. Install lamella by placing it on top of the starting fillet and adding fasteners to the upper edge of the lamella.

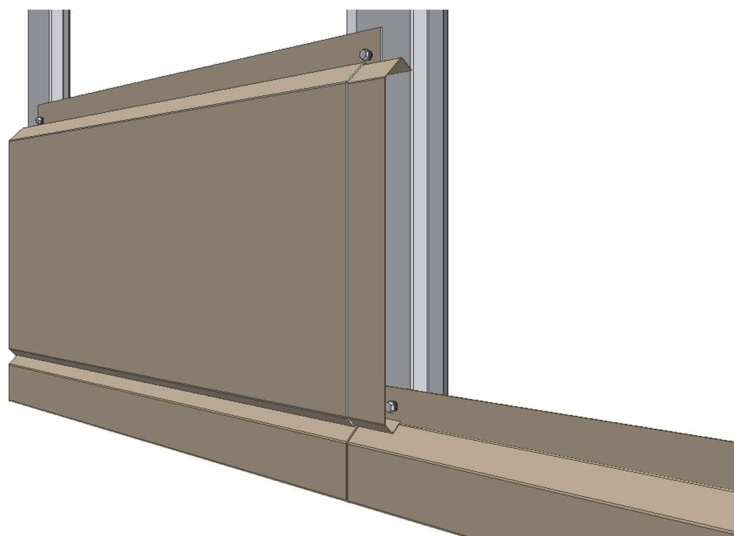

3. Add a joint piece on the end of lamella.

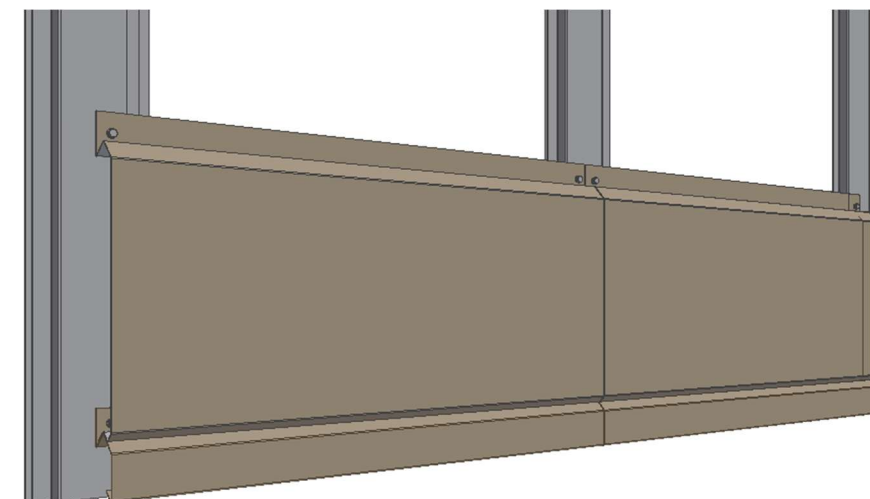

4. Continue with the next row of lamellas, leave a 2-3 mm vertical gap between them for thermal expansion.

Recommended fasteners:

- For fastening to support stud (e.g. CA1SS1), use screws S3H48022D02S4C
→ Note: This screw is not suitable for fastening to timber.

Use joint piece CA1JP10 between the lamellas.

Final execution must be according to the structural designer's instructions!

FOLLOW-UP OF THE DIMENSIONS

Follow the effective height. Check the dimensions from the plans!

Lamella tolerances:

- Effective height: ± 2 mm
- Width: ± 2 mm

Sub frame tolerances in horizontal direction:

- For one lamella: ± 1 mm
- Between each support stud: ± 1 mm

